

vtech[®]

Parent's Guide

Toot-Toot Animals

Adventure Safari



VTech understands that a child's needs and abilities change as they grow and with that in mind we develop our toys to teach and entertain at just the right level...

vtech Baby

Toys that will stimulate their interest in different textures, sounds and colours

I am...

...responding to colours, sounds and textures

...understanding cause and effect

...learning to touch, reach, grasp, sit-up, crawl and toddle

Birth-36 months



Pre-School

Interactive toys to develop their imagination and encourage language development

I want...

...to get ready for school by starting to learn the alphabet and counting

...my learning to be as fun, easy and exciting as can be

...to show my creativity with drawing and music so my whole brain develops

3-6 years



Electronic Learning Computers

Cool, aspirational and inspiring computers for curriculum related learning

I need...

...challenging activities that can keep pace with my growing mind

...intelligent technology that adapts to my level of learning

...National Curriculum based content to support what I'm learning at school

4-10 years



To learn more about this and other VTech® products, visit www.vtech.co.uk

INTRODUCTION

Thank you for purchasing the **Toot-Toot Animals Adventure Safari** play set by **VTech®**.

Enjoy an exciting adventure on the Adventure Safari. Learn about animals, colours and more with the **SmartPoint™** Monkey. Visit the Bear in the peek-a-boo cave, look at the view from the telescope on the treetop and take a trip to the waterfall with the roly-poly animals using the exciting zip line! For added fun, you can connect this play set to other Toot-Toot Animals play sets (each sold separately).

1 MOUNTAIN BASE WITH
NEST HOLE

6 **SMARTPOINT™**
LOCATIONS

1 ANIMAL ZIP LINE BASKET

1 TREE HOUSE BASE WITH
TURNING TELESCOPE

1 TREE HOLE

1 PEEK-A-BOO
BEAR CAVE

6 ROLY-POLY ANIMALS

1 RHINO SPINNING POOL

1 WATERFALL
RAMP

1 **SMARTPOINT™**
MONKEY

1 TURNING FLOWER

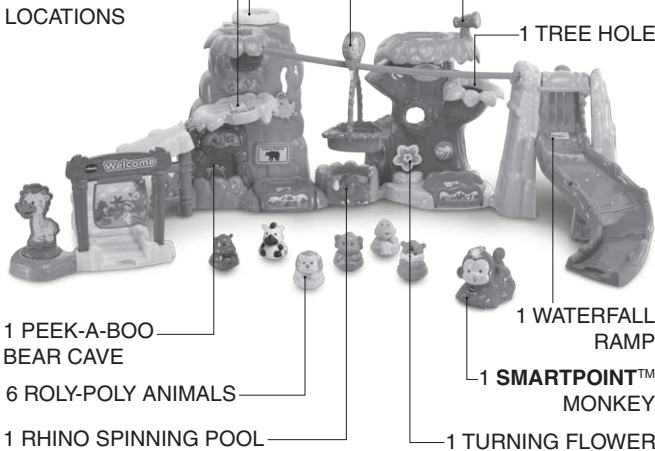

INCLUDED IN THIS PACKAGE

- One VTech® Toot-Toot Animals Monkey
- Six roly-poly animals



- One giraffe sign
- One bottom gate
- One tree ramp base
- One tree ramp top
- One gate
- Two support pillars



- One mountain base
- One small launching platform
- One **SmartPoint™** big launching platform
- One nest
- One **SmartPoint™** bear cave base



- One **SmartPoint™** turning telescope
- One tree house
- One **SmartPoint™** flower base
- One back tunnel
- One tunnel base



- One **SmartPoint™** waterfall ramp top
- One waterfall ramp middle
- One waterfall ramp base
- One waterfall header
- One left waterfall pillar
- One right waterfall pillar

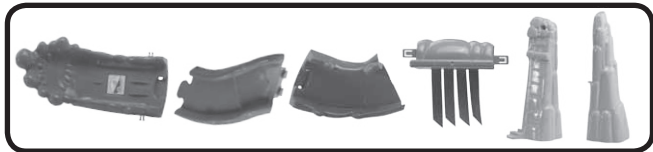

- One rhino spinning pool
- One long zip line
- One **SmartPoint™** basket for the zip line
- One sheet of labels
- One parent's guide

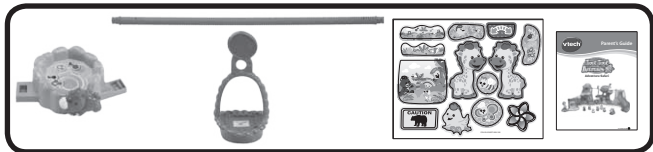

WARNING:

All packing materials such as tape, plastic sheets, packaging locks, removable tags, cable ties and packaging screws are not part of this toy, and should be discarded for your child's safety.

NOTE:

Please keep this parent's guide as it contains important information.

Unlock the packaging locks:

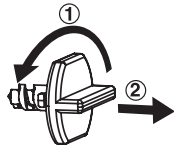

- ① Turn the packaging lock anticlockwise several times.
- ② Pull out and discard the packaging lock.

GETTING STARTED

BATTERY INSTALLATION – MONKEY

1. Make sure the unit is turned **OFF**.
2. Locate the battery cover on the bottom of the Monkey. Use a coin or a screwdriver to loosen the screw.
3. Install 2 new AAA (AM-4/LR03) batteries following the diagram inside the battery box. (The use of new alkaline batteries is recommended for maximum performance).
4. Replace the battery cover and tighten the screw to secure.

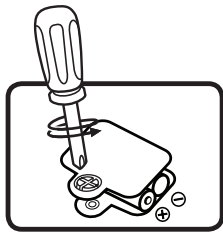

BATTERY NOTICE

- Use new alkaline batteries or fully charged NI-MH (Nickel Metalhydride) rechargeable batteries for best performance.
- Use only batteries of the same or equivalent type as recommended.
- Do not mix different types of batteries: alkaline, standard (carbon-zinc) or rechargeable (Ni-Cd, Ni-MH), or new and used batteries.
- Do not use damaged batteries.
- Insert batteries with the correct polarity.
- Do not short-circuit the battery terminals.
- Remove exhausted batteries from the toy.
- Remove batteries during long periods of non-use.
- Do not dispose of batteries in fire.
- Do not charge non-rechargeable batteries.
- Remove rechargeable batteries from the toy before charging (if removable).
- Rechargeable batteries are only to be charged under adult supervision.

Disposal of batteries and product



The crossed-out wheellie bin symbols on products and batteries, or on their respective packaging, indicates they must not be disposed of in domestic waste as they contain substances that can be damaging to the environment and human health.



The chemical symbols Hg, Cd or Pb, where marked, indicate that the battery contains more than the specified value of mercury (Hg), cadmium (Cd) or lead (Pb) set out in Battery Directive (2006/66/EC).

The solid bar indicates that the product was placed on the market after 13th August, 2005.

Help protect the environment by disposing of your product or batteries responsibly.

For more information, please visit:

www.recycle-more.co.uk

www.recyclenow.com

Please stick the labels to the play set securely as indicated below:

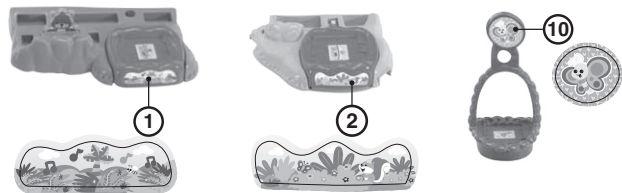
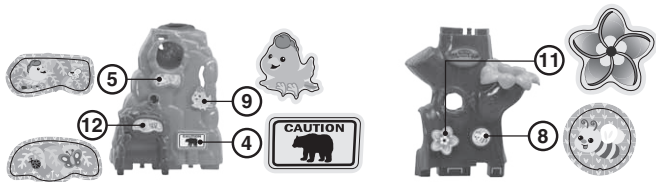
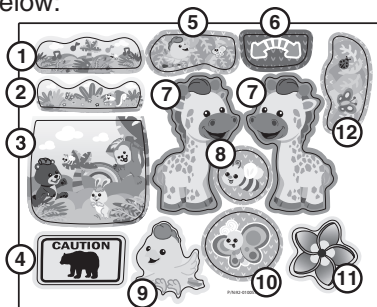

ASSEMBLY INSTRUCTIONS

With the **VTech® Toot-Toot Animals Adventure Safari**, safety comes first. To ensure your child's safety, adult assembly is required.

The Left Tree Ramp

1. Insert the giraffe sign into the base of the gate. You will hear a “click” to indicate the piece is secure.
2. Attach the base of the gate to the tree ramp base.
3. Insert the gate to the tree ramp base.
4. Connect the tree ramp base with the tree ramp top.
5. Insert the 2 support pillars under the tree ramp top.

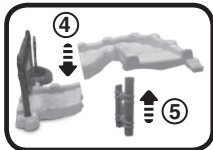
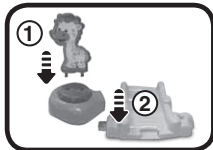

The Mountain

1. Insert the small launching platform into the mountain base above the hole.
2. Insert the **SmartPoint™** big launching platform into the mountain base below the hole. You will hear a “click” to indicate the piece is secure.
3. Insert the nest into the top of the mountain base. You will hear a “click” to indicate the piece is secure.
4. Attach the mountain base into the **SmartPoint™** bear cave base.

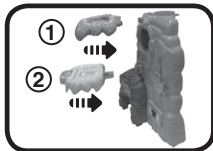

The Tree House

1. Attach the tree house to the **SmartPoint™** flower base.
2. Attach the **SmartPoint™** turning telescope to the top of the tree house.
3. Insert the back tunnel into the tree house.
4. Insert the tunnel base into the tree house.

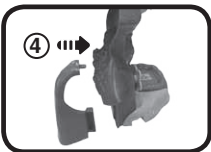
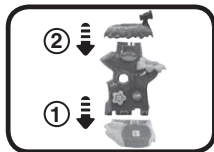

The Right Waterfall Ramp

1. Insert the **SmartPoint™** waterfall ramp top and the waterfall header into the left pillar and right pillar.
2. Connect the waterfall ramp middle and waterfall ramp base.
3. Connect the **SmartPoint™** waterfall ramp top, the waterfall ramp middle and waterfall ramp base. Insert the support piece under the waterfall ramp.

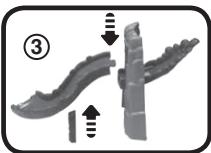

Connect all the parts

1. Locate the click hole below the **SmartPoint™** big launching platform and connect the left tree ramp with the mountain by connecting the ramp into the click hole. You will hear a “click” to indicate the piece is secure.
2. Use the Rhino spinning pool to connect the mountain base and the tree house. You will hear a “click” to indicate the pieces are secure.
3. Locate the click hole at the bottom of the tree house on the right side and connect the right waterfall ramp. You will hear a “click” to indicate the pieces are secure.
4. Attach the **SmartPoint™** basket to the long zip line. Insert the zip line into the left waterfall pillar and the small launching platform. You will hear a “click” to indicate the pieces are secure.



PRODUCT FEATURES – MONKEY

1. ON/OFF SWITCH

To turn the unit **ON**, slide the **ON/OFF SWITCH** to the **ON** (☺) position. To turn the unit **OFF**, slide the **ON/OFF SWITCH** to the **OFF** (●) position.

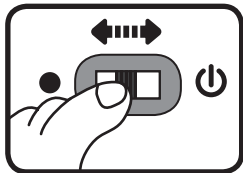

2. AUTOMATIC SHUT OFF

To preserve battery life, the **VTech® Toot-Toot Animals Monkey** will automatically shut off after approximately 60 seconds without input. The Monkey can only be turned on again by pressing the light up button, pushing the Monkey along quickly or by placing it on a **SmartPoint™** location.

NOTE: This product is in TRY-ME mode in the packaging. After opening the package, turn the Monkey **OFF** and then **ON** again to proceed with normal play. If the Monkey shuts off while playing, we suggest changing the batteries.

ACTIVITIES – MONKEY

1. Slide the **ON/OFF SWITCH** to the **ON** position to turn the unit **ON**. You will hear a Monkey sound, a song and a phrase. The light will flash with the sounds.

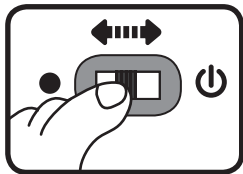

2. Press the **LIGHT UP BUTTON** to hear fun sounds, sing-along songs and phrases. The light will flash with the sounds.
3. Push the Monkey to hear fun sounds and melodies. While a melody is playing, push the Monkey again to add in fun sounds on top of the melody. The light will flash with the sounds.
4. For added fun, the Monkey interacts with other **VTech® Toot-Toot Animals** play sets (each sold separately). Simply roll the Monkey over one of the play set's **SmartPoint™** locations to see the light flash and to hear greetings, fun sounds, short tunes and sing-along songs.

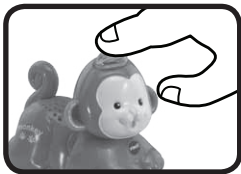

PRODUCT FEATURES - ADVENTURE SAFARI

1. Put a **SmartPoint™** animal on the bear cave **SmartPoint™** to say hello to the bear.



2. Put a **SmartPoint™** animal on the **SmartPoint™** flower platform to see the flower spin.



3. Push the **SmartPoint™** Monkey or the 6 roly-poly animals in the **SmartPoint™** basket along the zip line.



4. Put the roly-poly animals in the rhino pool and slide the rhino to spin the pool. Watch the animals spin round!



5. Twist the telescope on the **SmartPoint™** platform to look around.



6. Put the roly-poly animals into the hole on the top of the mountain and tree house and watch them roll out.



7. Push the animals from the top of the **SmartPoint™** waterfall and watch them slide to the bottom.



CARE & MAINTENANCE

1. Keep the unit clean by wiping it with a slightly damp cloth.
2. Keep the unit out of direct sunlight and away from any direct heat source.
3. Remove the batteries when the unit will not be in use for an extended period of time.
4. Do not drop the unit on hard surfaces and do not expose the unit to moisture or water.

TROUBLESHOOTING

If for some reason the **Toot-Toot Animals Monkey** stops working or malfunctions, please follow these steps:

1. Please turn the unit **OFF**.
2. Interrupt the power supply by removing the batteries.
3. Let the unit sit for a few minutes, then replace the batteries.
4. Turn the unit **ON**. The unit should now be ready to play again.
5. If the product still does not work, install a brand new set of batteries.

If the problem persists, please call our Consumer Services Department on 01235 546810 (from UK) or +44 1235 546810 (outside UK) and a service representative will be happy to help you.

IMPORTANT NOTE:

Creating and developing **VTech®** products is accompanied by a responsibility that we take very seriously. We make every effort to ensure the accuracy of the information, which forms the value of our products. However, errors sometimes can occur. It is important for you to know that we stand behind our products and encourage you to call our Consumer Services Department on 01235 546810 (from UK) or +44 1235 546810 (outside UK), with any problems and/or suggestions that you might have. A service representative will be happy to help you.

CLASS 1
LED PRODUCT



PRODUCT REGISTRATION

Visit www.vtech.co.uk/clubvtech/login
to register your VTech product

By joining the VTech Club you can also enter competitions, find out about news and events, seek expert advice for parents and let your kids play fun learning games and activities.



PRODUCT WARRANTY

Thank you for choosing this quality product from VTech. We hope it will bring many hours of entertainment, imaginative play and learning.

1. The product detailed above is covered by a one year warranty from the date of purchase, against any defects in materials or workmanship.
2. The product may be returned to the place of purchase. Alternatively the product can be returned to VTech Electronics Europe plc (see address below), with proof of purchase, without proof of purchase no replacement will be provided.
3. VTech Electronics Europe plc will examine the product and if it is found to be defective due to faulty materials or workmanship, will replace the product at their discretion.
4. If the product covered by this warranty is damaged due to misuse, modification or unauthorised repair, or because of faulty batteries, battery discharge or incorrect electrical connections, then this warranty becomes void.
5. This warranty is personal to the original purchaser and is not transferable.
6. Breakages to the LCD screen are not covered by the warranty.
7. Returns to VTech Electronics Europe plc should include a cheque or postal order for £1.50 towards the cost of return postage and packaging.
8. Products returned to VTech Electronics Europe plc, should be addressed as follows and packed carefully to avoid damage in transit (Please do not include batteries or adaptor). Please include details of the fault together with your name and address.
9. To keep an online record of your warranty, please register your product online at www.vtech.co.uk/warranty

Vtech Electronics EU PLC, c/o XPO Logistics, Warehouse 350, Cat & Fiddle Lane, West Hallam, DE7 6HE

THIS WARRANTY IS OFFERED AS AN EXTRA BENEFIT AND DOES NOT AFFECT CONSUMERS' STATUTORY RIGHTS.

This warranty is valid for the UK and Eire only. For products purchased outside the UK and Eire, please contact your local distributor or place of purchase.



**Visit our website for more
information about our products,
downloads, resources and more.**

www.vtech.co.uk

